

CONTRACT: DN01056

STATE OF NORTH CAROLINA
DIVISION OF HIGHWAYS

SWAIN/JACKSON COUNTY

LOCATION: *SR 1337 (DEEP CREEK RD)*
SR 1356 (SAVANNAH DR)

TYPE OF WORK: *SIDEWALK, CURB RAMPS,*
PAVEMENT MARKINGS

STATE	STATE PROJECT REFERENCE NO.	SHEET NO.	TOTAL SHEETS
N.C.	DN01056	11	
STATE PROJ. NO.	F. A. PROJ. NO.	DESCRIPTION	
49336.1.27	4933604	P.E.	
49336.3.27	4933604	CONSTRUCTION	
49336.1.31	4933608	P.E.	
49336.3.31	4933608	CONSTRUCTION	

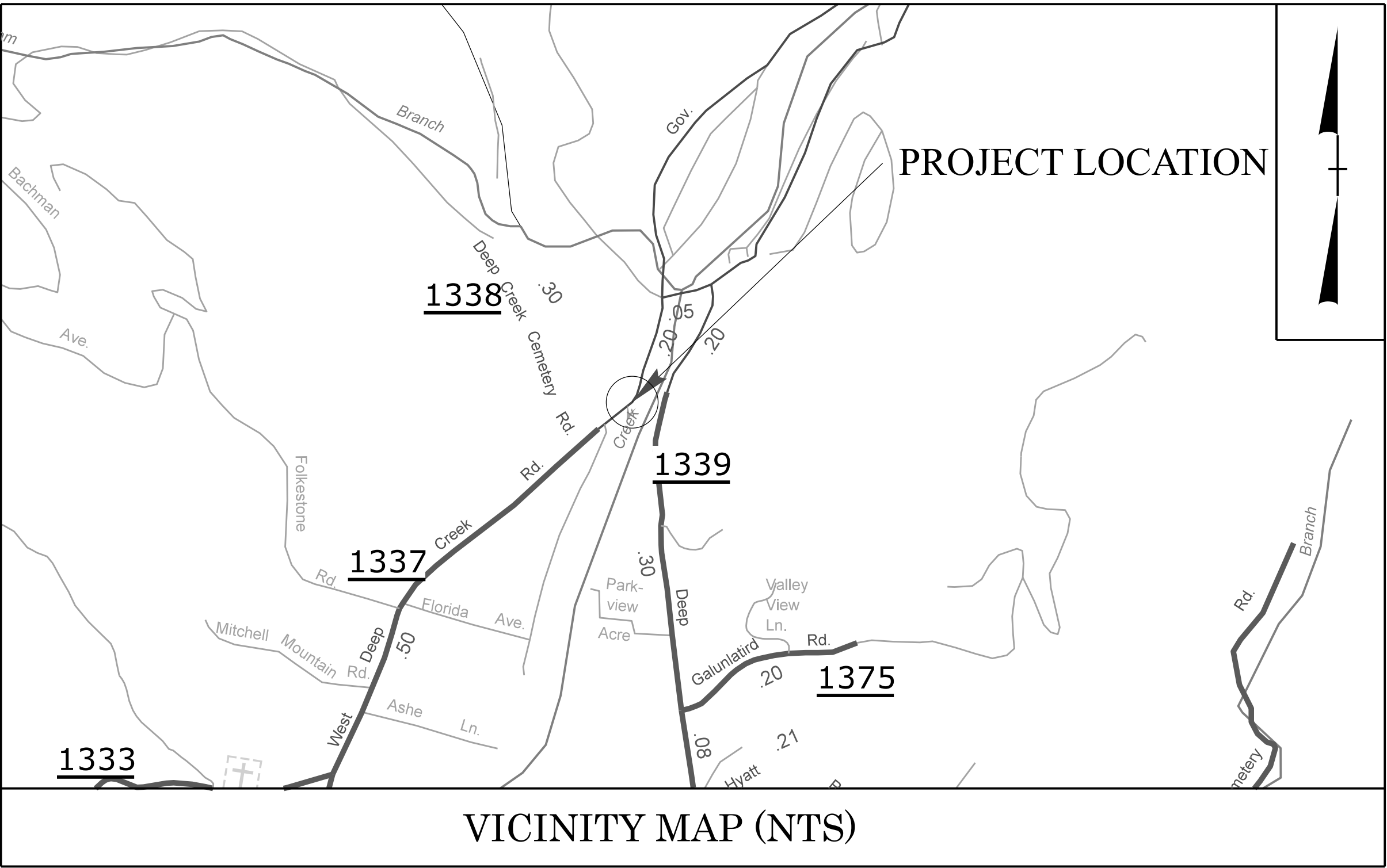

HS-2014Z

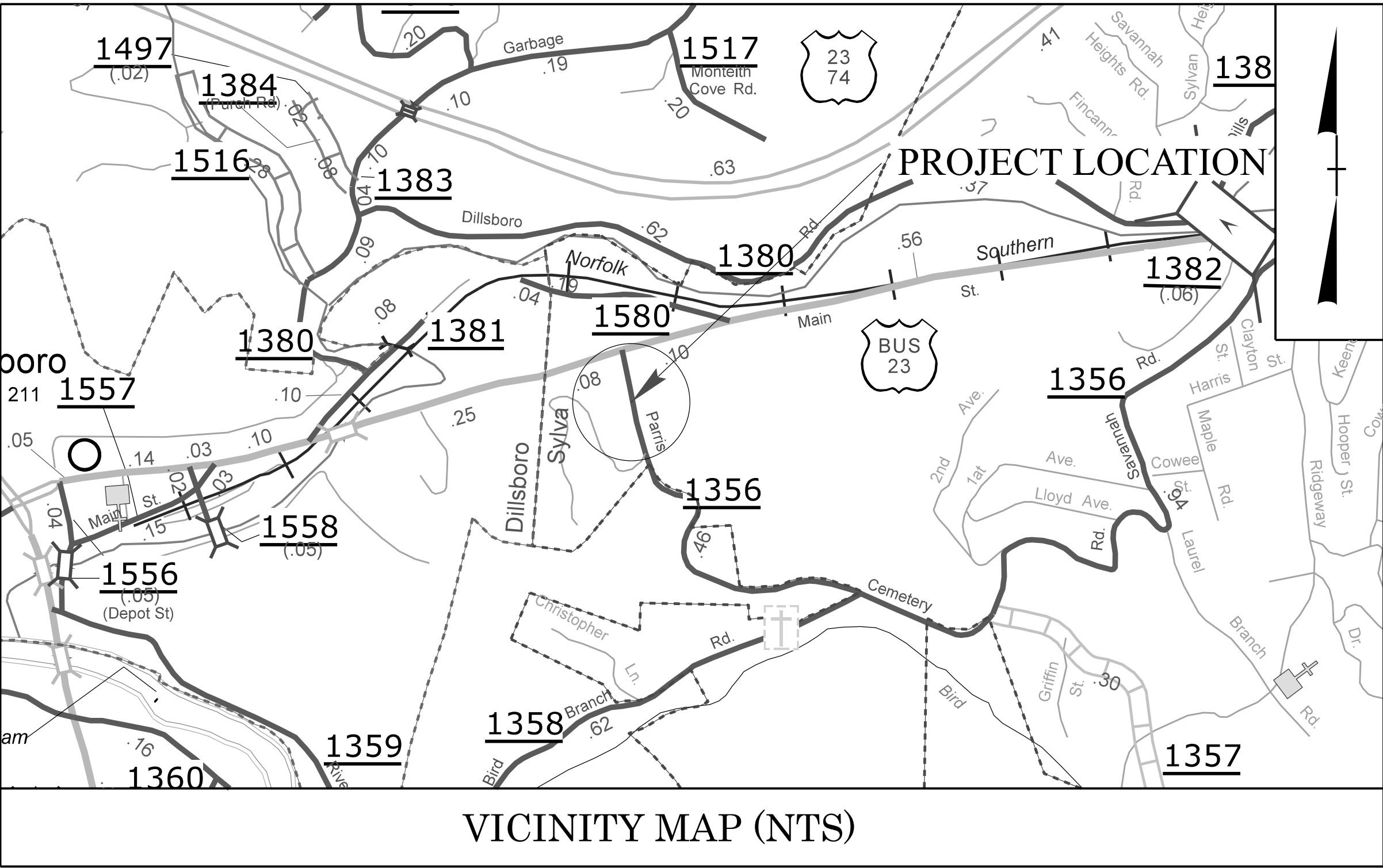

HS-2014AD

DOCUMENT NOT CONSIDERED FINAL
UNLESS ALL SIGNATURES COMPLETED

GRAPHIC SCALES

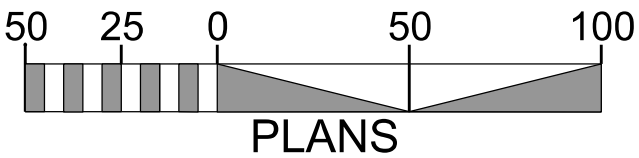

PROJECT LENGTH

TOTAL LENGTH OF TIP HS-2014Z : 0.018 MILES
TOTAL LENGTH OF TIP HS-2014AD ; 0.112 MILES

Prepared in the Office of:
DIVISION OF HIGHWAYS
253 Webster Rd., Sylva NC, 28779

2024 STANDARD SPECIFICATIONS

RIGHT OF WAY DATE:
N/A

LETTING DATE:
SEPTEMBER 9, 2025

JAMES HOLLINGSWORTH, PE
PROJECT ENGINEER

JAMES HOLLINGSWORTH, PE
PROJECT DESIGN ENGINEER

HYDRAULICS ENGINEER

7/7/2025

DocuSigned by:
James Hollingsworth
SIGNATURE: P.E.

ROADWAY DESIGN ENGINEER

7/7/2025

DocuSigned by:
James Hollingsworth
SIGNATURE: P.E.

